



FLUID TRANSFER SYSTEMS

Metric

Product Description

Kongsberg Automotives Smoothbore Metric Range is designed to accept standard hydraulic tailed fittings. The ID of the hoses are made slightly larger than the Imperial Range so helps reduce the insertion force required to make assemblies. The Metric hose range was designed to help reduce Hydraulic rubber users reduce their inventory with only needing to stock one fitting to suit all hoses.

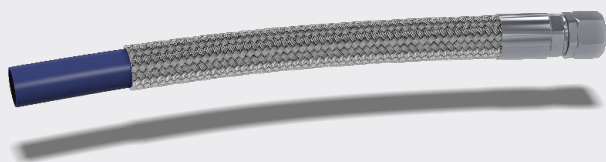

Properties

Application	Used globally in the Industrial, Chemical, Pharmaceutical, Automotive and Food industries when lesser hoses can't cope with the temperature, pressure, cleanliness or flex fatigue.
Design	Smoothbore PTFE tube with high tensile SS 304 braid in metric sizing
Inner layer	Medium wall smoothbore PTFE tube
Outer Layer	High tensile 304 maypole wound Stainless Steel braid
Temperature Min / Max	-60°C to +260°C (-76°F to +500°F)
Material	PTFE according to "ISO12086, Part 1.PTFE-E.P.D.M 1.6.1.C.E.4_12"

Metric Range

USA Part Number	Part Number	Description	Braided ID Nominal		Tolerance		Braided OD Nominal		Tolerance		Tube Wall Thickness Nom.		Max. Working Pressure		Min. Burst Pressure		Min Bend Radius	
			(mm)	(in)	(mm)	(in)	(mm)	(in)	(mm)	(in)	(psi)	(bar)	(psi)	(bar)	(mm)	(in)		
TSSV4.9B01	TSSV4.9B01	4.9mm STD	4.93	0.193	0.4	0.016	7.77	0.31	0.6	0.024	0.89	0.035	4,000	276	12,000	827	51	2.0
TSSV5.1B01	TSSV5.1B01	5.1mm STD	5.1	0.201	0.4	0.016	8.05	0.317	0.6	0.024	0.89	0.035	3,830	264	11,500	793	64	2.5
TSSV6.7B01	TSSV6.7B01	6.7mm STD	6.77	0.264	0.4	0.016	9.35	0.368	0.6	0.024	0.76	0.03	3,250	224	9,750	672	76	3.0
TSSV8.0B01	TSSV8.0B01	8.0mm STD	8	0.315	0.4	0.016	11.3	0.445	0.6	0.024	0.89	0.035	3,160	218	9,500	655	102	4.0
TSSV8.4B01	TSSV8.4B01	8.4mm STD	8.4	0.331	0.4	0.016	11.6	0.435	0.6	0.024	0.64	0.025	3,000	207	9,000	621	102	4.0
TSSV10.0B01	TSSV10.0B01	10.0mm STD	10	0.394	0.4	0.016	12.65	0.498	0.6	0.024	0.64	0.025	2,660	183	8,000	552	127	5.0
TSSV10.3B01	TSSV10.3B01	10.3mm STD	10.3	0.406	0.4	0.016	13.44	0.529	0.6	0.024	0.89	0.035	2,660	183	8,000	552	133	5.2
TSSV13.2B01	TSSV13.2B01	13.2mm STD	13.2	0.52	0.5	0.02	16.55	0.652	0.75	0.03	0.89	0.035	2,330	161	7,000	483	152	6.0
TSSV13.6B01	TSSV13.6B01	13.6mm STD	13.6	0.535	0.5	0.02	17.15	0.675	0.75	0.03	0.89	0.035	2,330	161	7,000	483	150	5.9
TSSV16.6B01	TSSV16.6B01	16.6mm STD	16.6	0.654	0.5	0.02	19.75	0.778	0.75	0.03	0.89	0.035	1,660	114	5,000	345	178	7.0
TSSV19.8B01	TSSV19.8B01	19.8mm STD	19.8	0.78	0.6	0.024	22.96	0.904	0.85	0.033	0.89	0.035	1,500	103	4,500	310	203	8.0
TSSV22.1B01	TSSV22.1B01	22.1mm STD	22.1	0.87	0.6	0.024	25.38	0.995	0.85	0.033	0.89	0.035	1,330	92	4,000	276	229	9.0
TSSV26.1B01	TSSV26.1B01	26.1mm STD	26.1	1.028	0.6	0.024	30.45	1.152	0.85	0.033	0.89	0.035	1,160	80	3,500	241	305	12.0

Note

Antistatic liners are available for the Metric range for when electrically resistive fluids are being transferred at high flow rates. Both two wire braid, 316 stainless steel braid and Heavy Wall derivatives are available for this range. Please contact our sales team for more information on these products.