



FLUID TRANSFER SYSTEMS

SAE 100 R14

Product Description

Kongsberg Automotives SAE 100R14 Range is a smoothbore PTFE lined hose that is made to meet or exceed the SAE 100R14 specification. This range is also available in USA with a fully validated range of fittings and ferrules for your added safety.

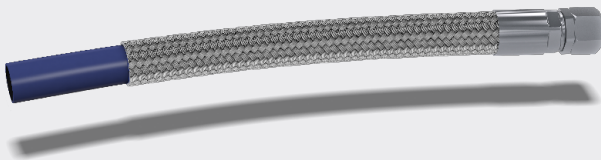

Properties

Application	Used in stringent applications that need the protection of a hose that meets or exceeds SAE 100 R14 standard.
Design	Smoothbore PTFE tube with high tensile SS 304 braid to the SAE 100 R14 Standard
Inner layer	Medium wall smoothbore PTFE tube
Outer Layer	High tensile 304 maypole wound
Temperature Min / Max	-60°C to +260°C (-76°F to +500°F)
Material	PTFE according to "ASTM D4895, Type 1, Grade 4, Class B"

SAE 100 R14 Range

USA Part Number	Part Number	Description	Tube Wall Thickness Nom.		Braid OD Nominal		Tolerance +/-		Braid ID Nominal		Tolerance +/-		Max. Working Pressure		Min. Burst Pressure		Min. Bend Radius	
			(mm)	(in)	(mm)	(in)	(mm)	(in)	(mm)	(in)	(psi)	(bar)	(psi)	(bar)	(mm)	(in)		
T1167-03	TSRV3-4B01	DASH 3 SAE 100 R14	1.02	0.04	6.7	0.26	0.4	0.02	3.35	0.13	0.25	0.01	3002	207	11995	827	38	1.50
T1167-04	TSRV4-9B01	DASH 4 SAE 100 R14	0.7	0.03	7.65	0.30	0.5	0.02	4.9	0.19	0.35	0.01	3002	207	11995	827	51	2.01
T1167-05	TSRV6-5B01	DASH 5 SAE 100 R14	0.7	0.03	9.5	0.37	0.5	0.02	6.51	0.26	0.4	0.02	2625	181	10501	724	76	2.99
T1167-06	TSRV7-9B01	DASH 6 SAE 100 R14	0.7	0.03	11	0.43	0.6	0.02	8.1	0.32	0.45	0.02	2495	172	10008	690	100	3.94
T1167-07	TSRV9-5B01	DASH 7 SAE 100 R14	0.71	0.03	12.6	0.50	0.6	0.02	9.7	0.38	0.45	0.02	2248	155	9007	621	127	5.00
T1167-08	TSRV10-5B01	DASH 8 SAE 100 R14	0.71	0.03	13.61	0.54	0.7	0.03	10.57	0.42	0.5	0.02	2002	138	8006	552	133	5.24
T1167-10	TSRV12-8B01	DASH 10 SAE 100 R14	0.76	0.03	16.1	0.63	0.7	0.03	12.95	0.51	0.5	0.02	1494	103	6005	414	165	6.50
T1167-12	TSRV15-9B01	DASH 12 SAE 100 R14	0.85	0.03	19.38	0.76	0.75	0.03	16.1	0.63	0.6	0.02	1247	86	5004	345	197	7.76
T1167-14	TSRV19-0B01	DASH 14 SAE 100 R14	0.85	0.03	22.55	0.89	0.8	0.03	19.21	0.76	0.6	0.02	1102	76	4395	303	229	9.02
T1167-16	TSRV22-2B01	DASH 16 SAE 100 R14	0.89	0.04	25.78	1.01	1.2	0.05	22.22	0.87	0.8	0.03	1001	69	4003	276	229	9.02
T1167-18	TSRV25-4B01	DASH 18 SAE 100 R14	1.10	0.04	29.75	1.17	1.2	0.05	25.4	1.00	0.8	0.03	899	62	3597	248	305	12.01

Note: USA part numbers - see imperial data. Other part numbers - see metric data

Note

Antistatic liners are available for the SAE 100 R14 range for when electrically resistive fluids are being transferred at high flow rates. Please contact our sales team for more information on these products.